

INSTITUTE FOR FISHERIES RESEARCH  
 DIVISION OF FISHERIES MICHIGAN CONSERVATION DEPT.  
 LAKE INVENTORY MAP  
**HERENDEENE LAKE**  
 AREA 36 ACRES  
 MARGINAL SURVEY AND SOUNDINGS BY  
 LAKE & STREAM IMPROVEMENT SECTION 1/9-11,16,18,22,23/63  
 BENZIE COUNTY T.27N.,R.13W., SEC.15



Great lake for peace and quiet! This is another good lake for bass and bluegill fishing. In 2009, a master angler bluegill of 12.25 inches was registered! The area in red is Fuller Lake which is connected via a small canal. It's not very deep back here but there are lots of hiding spots for bass and panfish! Make sure you have oars. Fish the lily pads and dropoffs in the summer all over the lake. Few people ice fish it because the road to the launch is steep so there's a chance of getting stuck. Just up the road is a really cool covered bridge you should definitely check out! There is a fair amount of shoreline here you can fish even if you don't have a boat.

B. M. NO. 1=100.0—SPIKE IN BASE  
 OF 24" WHITE PINE  
 WATER SURFACE ELEVATION = 99.9  
 1/23/63

B. M. NO. 2=100.0—SPIKE IN BASE  
 OF 20" WHITE PINE  
 WATER SURFACE ELEVATION = 99.1  
 1/23/63

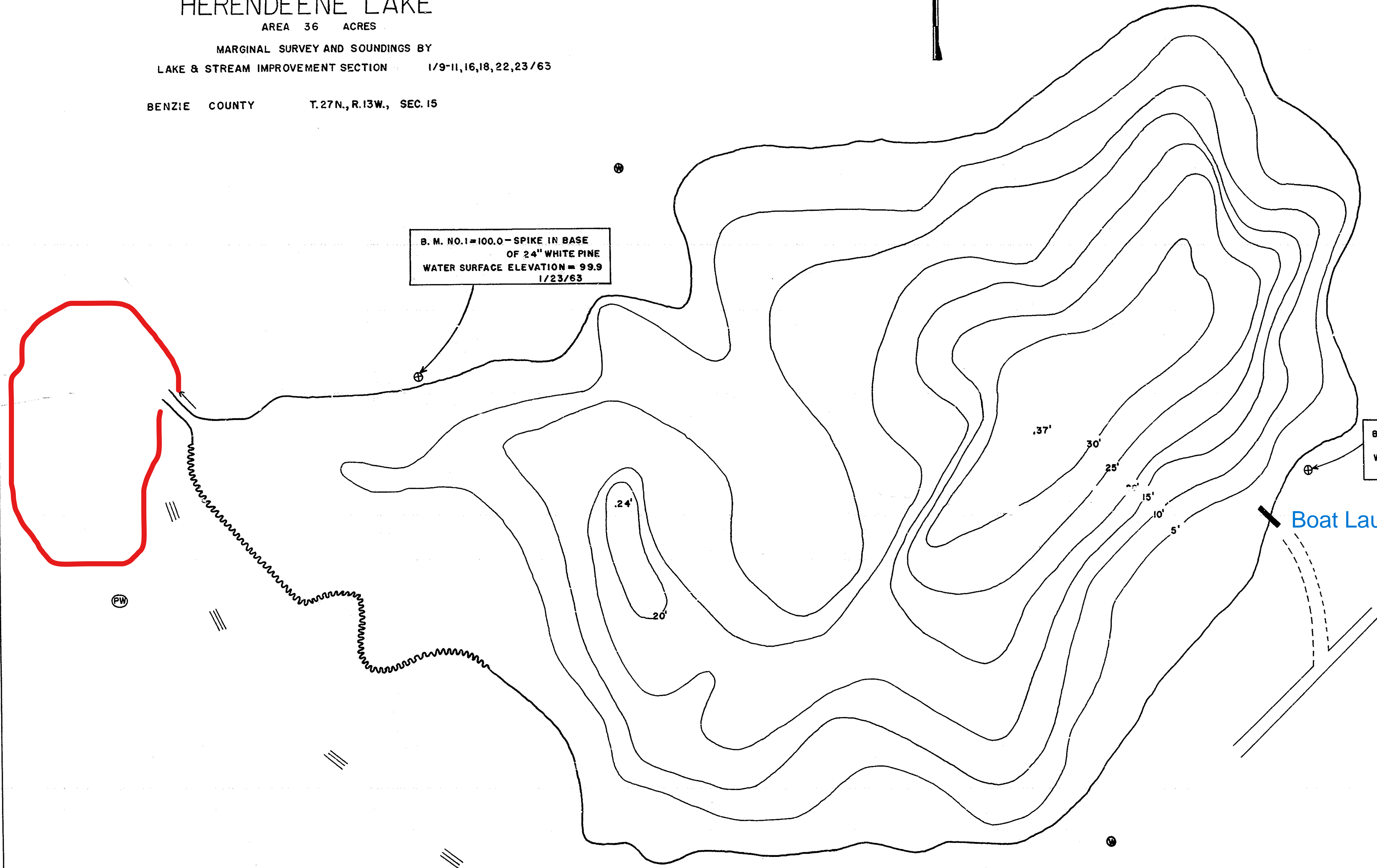

LEGEND

- BOTTOM**  
 □ Marl
- OUTLINE & CONTOURS**  
 ~ Shoreline  
 ~~~ Encroaching shore  
 -s- Contours
- SHORE FEATURES**  
 ≡ Steep slope  
 ⊙ Wooded  
 ⊙ Partly wooded  
 ⊙ Cleared land  
 = Improved road  
 - - - Unimproved road  
 — Dock  
 ← Outlet

